



©BNE Real Estate



23 Winchcombe Ave MURRUMBA DOWNS, QLD



4



2



2

One of the best streets in Castle Hill Estate on 1100m2

- Sleek and modern interiors have been finished to a very high standard
- A spacious split level layout features formal and casual living areas
- Brand-new island kitchen fitted with high-end fixtures and appliances
- Private parklike grounds include a swimming pool and poolside gazebo
- Ground level master suite with walk-in wardrobe and brand-new ensuite
- Double bedrooms each have built-ins, full bathroom and a large laundry
- Double lock-up garage, air-conditioning, storage shed and extra parking
- Easy access to playing fields, John Oxley Reserve and Pine River walking trails

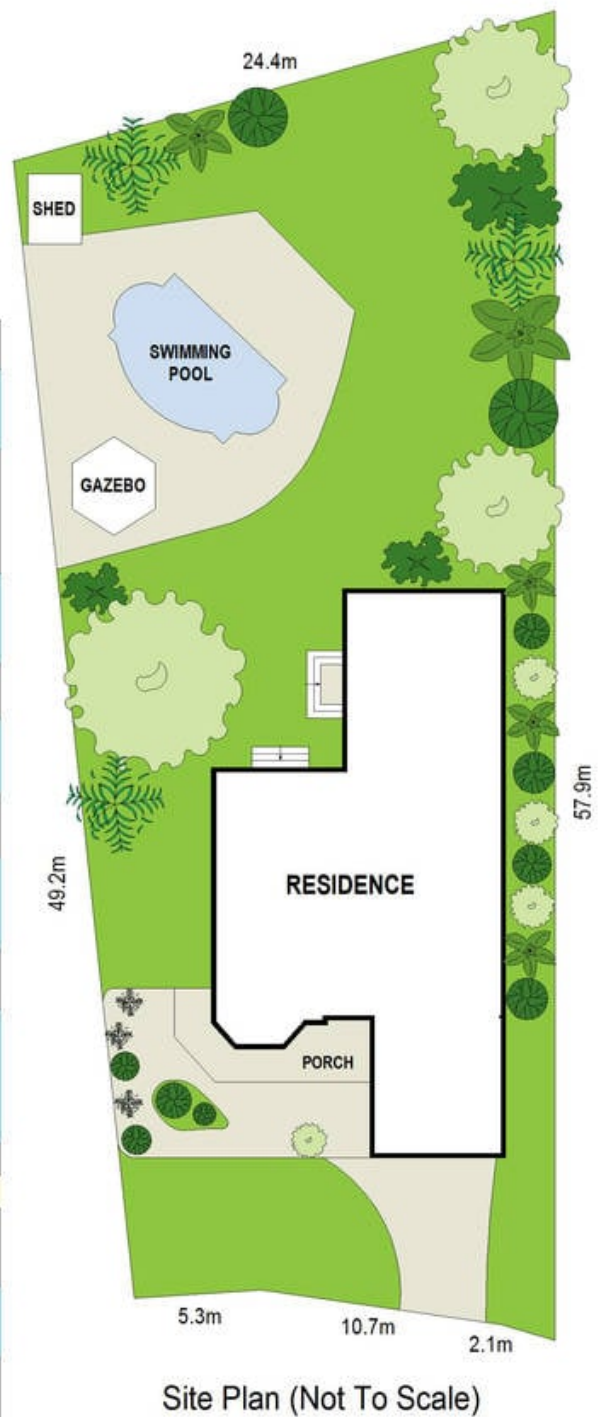

23 Winchcombe Avenue, Murrumba Downs

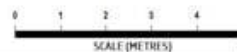

Scale in metres. Indicative only. Dimensions are approximate. All information contained here in is gathered from sources we believe to be reliable. However we cannot guarantee its accuracy and interested persons should rely on their own enquiries. Floor Plan by Digital Real Estate. www.digitalre.com.au